

CAERPHILLY COUNTY BOROUGH COUNCIL
PUBLIC PATH EXTINGUISHMENT ORDER
TOWN AND COUNTRY PLANNING ACT 1990, SECTION 257

This order is made by Caerphilly County Borough Council ("the Authority") under Section 257 of the Town and Country Planning Act 1990 because it is satisfied that it is necessary to stop up a section of the footpath to which this order relates in order to enable development to be carried out in accordance with planning permission granted under Part III of the Town and Country Planning Act 1990 namely residential development at Mackworth Grange. Two new footpaths will be created to replace this section of Footpath No. 54 in the Community of Caerphilly

BY THIS ORDER:

1. The footpath over land at Pont-y-Pandy Farm (Mackworth Grange) Caerphilly and shown by a continuous bold black line on the attached map and described in Part I of the Schedule to this Order ("the Schedule") shall be stopped up provided below
2. There shall be created to the reasonable satisfaction of the Caerphilly County Borough Council alternative highways for use as a replacement for the said footpath as provided in Part 2 of the Schedule and shown by black dashes on the attached map.
3. The stopping of the footpath shall have effect on the date on which the Authority certify that the terms of Article 2 above have been complied with.

Taylor Wimpey South Wales are hereby required to make details of payments for the cost of carrying out the said works.

Where immediately before the date on which the footpath is stopped up there is apparatus under, in, on, over, along or across it belonging to statutory undertakers for the purpose of carrying on their undertaking, the undertakers shall continue to have the same rights of the apparatus as they then had.

SCHEDULE

PART 1

Description of site of existing path or way

That part of Footpath No. 54 in the Community of Caerphilly, commencing at a point approximately 110 metres west of the centre of the property known as Pont-y-Pandy Farm (Grid ref: 15630 88743) and proceeding in a south-easterly direction to its junction with Footpath No. 55 in the Community of Caerphilly, at a point approximately 40 metres south of the centre of the aforementioned property (Grid Ref: 15725 88644). Indicated in the Order Map as B-A. A total distance of 136 metres.

PART 2

Description of site of alternative highway

A new path to a width of 1.8 metres commences on Footpath No. 56 in the Community of Caerphilly at a point 132 metres south-east of the centre of the Catnic Factory (Grid Ref: 15613 88719). It proceeds in a south easterly direction, following the estate footways to its termination at a point 270 metres south-east of the aforementioned factory to join Footpath No. 55 in the Community of Caerphilly (Grid ref: 15727 88645). A total distance of 216 metres. The new footpath to be identified as Footpath No. 54A in the Community of Caerphilly as indicated on the Order Map as H-G-F-E-J-C-A.

A new path with a width of 1.2 metres, commences on Footpath No. 54A in the Community of Caerphilly at a point 146 metres south-east of the centre of the Catnic Factory (Grid Ref: 15613 88707), proceeds in a south easterly direction where it re-joins Footpath 54A in the Community of Caerphilly at a point 264 metres south-east of the aforementioned factory (Grid Ref: 15715 88641). A total distance of 165 metres. The new footpath to be identified as Footpath No. 54B in the Community of Caerphilly as indicated on the Order Map as G-E-D-C.

Dated the 4th day of March 2015

The Common Seal of
Caerphilly County Borough Council
was hereunto affixed
in the presence of:

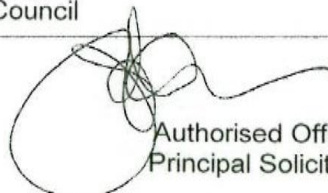
Authorised Officer
Principal Solicitor

20154

CAERPHILLY COUNTY BOROUGH COUNCIL
Town and Country Planning Act 1990 - Section 257
Extinguishment of a section of Footpath No. 54
in the Community of Caerphilly and Creation of Two
Alternative Footpaths
Public Path Extinguishment Order 2015

Document No. 5

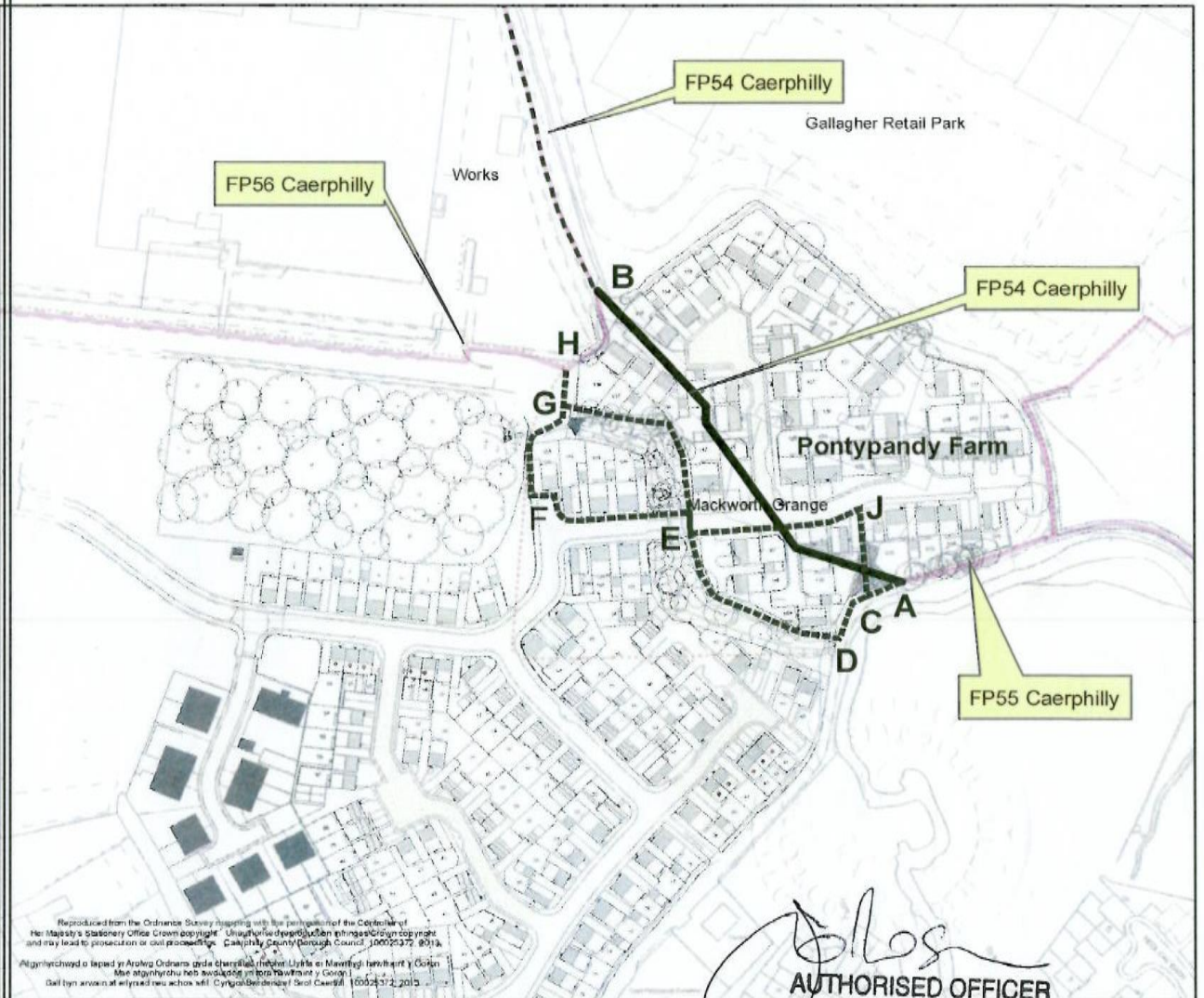

Reproduced from the Ordnance Survey mapping with the permission of the Controller of Her Majesty's Stationery Office Crown copyright. Unauthorised reproduction infringes Crown copyright and may lead to prosecution or civil proceedings. Caerphilly County Borough Council 100025372, 2015.
 Nighnyrchod o lepar y Arrolwg Ordnans gŵir a cherdded y Llysoedd a Mawrthg Grange y Goron.
 Mae atgynhyrchu heb awdoddiad yn torri hysbysu y Goron.
 Gall bryn arwain at wylwedd neu achos sefili. Cyfnewid/bereddwyl/ Berol Caerphilly 100025372, 2015.

Highways at: Mackworth Grange Residential Development, Caerphilly

| | | |
|--|---|--|
| <p>Extinguishment of Highway A-B </p> <p>New Highways H-G-F-E-J-C-A FP54A Caerphilly </p> <p>New Highway G-E-D-C FP54B Caerphilly </p> | <p>Scale: 1:2,000</p> <p>O.S. Sheet No. ST19 Ref: ETP/ROW FP54 Caerphilly</p> | <p>Given under the common seal of the Caerphilly County Borough Council this day of <i>17/11/15</i> in the year Two Thousand and Fifteen</p> |
|--|---|--|

